

In-Store Fan Display



Model 705CA



RR 2 • Warton • Ontario • Canada • N0H 2T0
TEL (519) 534-1080 • TOLL FREE 1-800-567-3556
FAX (519) 534-1088 • www.caframo.com/705.html

CAFRAMO IN-STORE FAN DISPLAY

The Caframo In-Store Display is designed to give the customer an opportunity to experience the unique features of any of the various Caframo 12 volt fans within a 20 second time frame.

Please note that only one fan can be operated at a time.

PREPARING THE IN-STORE DISPLAY FOR USE





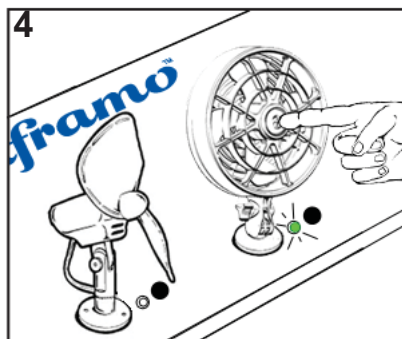
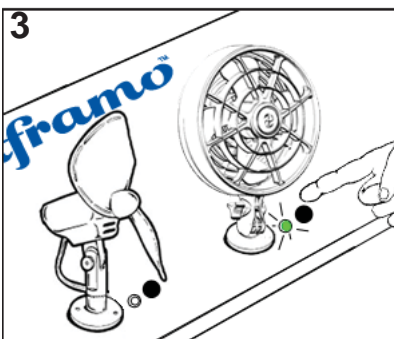
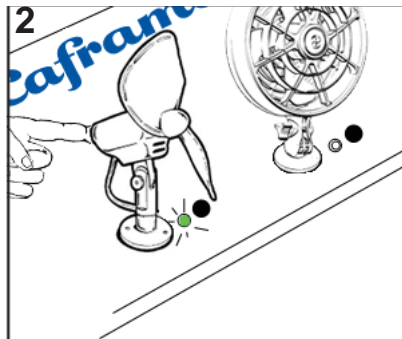
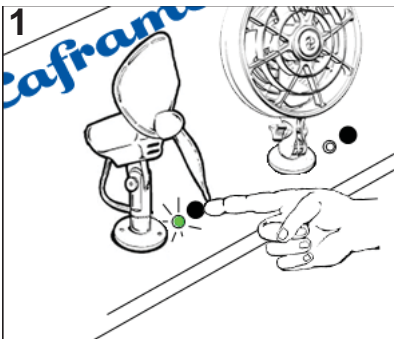

1. Remove the Display from its environmentally friendly packing.
2. Securely attach the Display to standard shelving using the 4 bolts and wing nuts found on the bottom of the Display.
3. Plug the male lighter plug (which has been disconnected for shipping) into the EZ PowerPak on the right hand side of the display.

OPERATING THE IN-STORE DISPLAY (SEE DIAGRAMS BELOW)

1. Push any of the black activation buttons beside the fans. This will power up the individual fan for 20 seconds as indicated by the green power light turning on.
2. Now operate the specific fan's speed or timer controls.
3. To test a different fan, push its black activation button and the green power light will turn on while the previous fan turns off. This restarts the timer for a full 20 seconds.
4. Now operate the controls of the second fan and continue the process until all fans have been tested. The display will automatically be shut down.



PRODUCT INFORMATION

Fan	Name/ WM SKU	Features	Benefits
	Sirocco 062503807012	<ul style="list-style-type: none"> * Three speeds * Ultra quiet, long-life motor * 2, 4, 6, 8 hour timer * Draws 0.4 Amps on high 	<ul style="list-style-type: none"> * 360° rotation for limitless positioning * Turns off automatically * Stows out of way
	Bora 062503748032	<ul style="list-style-type: none"> * Three speeds * Long life motor * Newly designed high efficiency blade * Draws 0.3 Amps on high 	<ul style="list-style-type: none"> * Maximum airflow with minimum noise * Safety from fully-guarded blade * Battery friendly
	Ultimate 062503747431	<ul style="list-style-type: none"> * Two speeds * Two mounting options (permanent or removable suction cup) * Draws 0.5 Amps on high 	<ul style="list-style-type: none"> * Maximum airflow * Quiet, dependable operation * Fan stays in place in rough seas
	Camano 062503743013	<ul style="list-style-type: none"> * Compact design * Single speed * High efficiency blade * Draws 0.3 Amps on high 	<ul style="list-style-type: none"> * Economical * Mount in any orientation (up, down or sideways) * Easy to use controls
	Sanibel 062503760003	<ul style="list-style-type: none"> * On/Off Oscillating action * Adjustable head * Fully guarded * Draws 0.5 Amps on high 	<ul style="list-style-type: none"> * Economical * Safe to use * Easy to install * Moves air throughout cabin
	EZ PowerPak 062503902007	<ul style="list-style-type: none"> * Waterproof * Built in battery tester * Standard lighter plug compatible * Shoulder strap included 	<ul style="list-style-type: none"> * Dependable 12V power * Portable emergency power source * Charge cell phone, operate portable fish finders, VHF, GPS, etc.

HOW TO CLEAN

A common household window cleaner is suggested as it will not harm the products or the display board.

HOW TO CHECK BATTERY LIFE ON EZ POWERPAK

1. Ensure all fans are turned off.
2. Press the red battery test button on the EZ PowerPak.

Green light lit = Batteries are OK.

Red and green light lit = Batteries are low and should be changed soon.

Red light lit = Batteries are dead. Change immediately.

TROUBLESHOOTING

Symptom #1: Green indicator light does not light when black button is pushed.

Possible Problem: Battery Pak is unplugged or batteries are dead.

Solution: 1. Check that EZ PowerPak connection is secure.

2. Press red button on EZ PowerPak to test batteries.

If green light is lit, batteries are charged.

If both green and red lights are lit, batteries should be changed shortly.

If red light is lit, batteries are dead and should be changed immediately.

Symptom #2: One fan does not run

Possible Problem: Wiring disconnected

Solution: 1. Check wiring of the defective fan.

Fans are connected using a removable wire nut, ensure both wire nuts are secure.

Symptom # 3: One fan runs slowly

Possible Problem: Batteries are getting run down - higher drawing fans will slow down sooner than others

Solution: See solution for Symptom #1

Symptom #4: All fans run slowly or for less than 20 seconds

Possible Problem: Batteries are getting run down

HARDWARE INCLUDED WITH IN-STORE DISPLAY:

4 - 1" 832 Phillips panhead machine screws

4 - 832 wing nuts

4 - 3/4" flat washers

**For further information please visit:
www.caframo.com/705.html**